



01442 260586

TS-700

HOSPITALITY TOUCH SCREEN SYSTEM

A touch screen system for all Hospitality applications including Fast Food, Café, Bistro, Restaurant, Bar and Night Club



TS-700 Touch Screen EPOS



Bright 12.1" TFT colour LCD panel
With up to 84 screens



Optional hardware for system building plus powerful back office



Good looks and intelligent connectivity

The TS-700 has been designed to cope with every aspect of the hospitality market. Up to 84 screens can be programmed to suit a variety of applications. The terminal can function as a stand alone unit or multiple terminals can be configured with optional hard and soft ware for flexible system building.

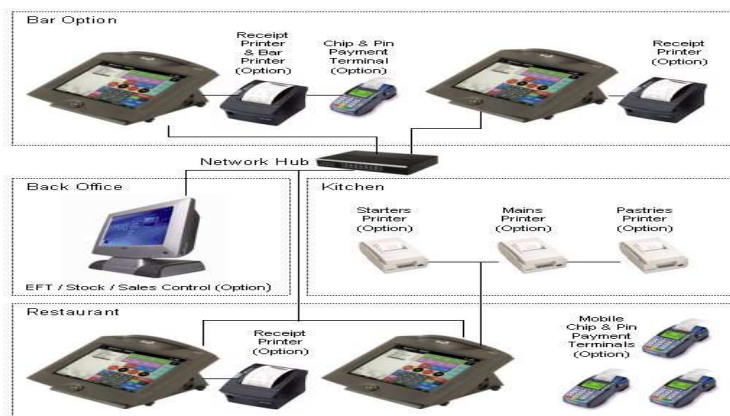

- Up to 84 screens, up to 100 buttons per screen
- User definable button shape colour and size
- Table layout facility, design your own restaurant
- Split bills by item and by seat
- Good looks and intelligent connectivity
- Assign customer name to bar tabs, transfer to tables, then transfer to account
- Up to 4 timed periods with linked prices and screens
- Real time count of menu items advising on availability
- Touch edit facility, ideal for programming daily specials

System Features

12.1" TFT colour LCD panel (800 x 600 SVGA)
Resistive touch panel
All in one low power pc board

I/O Interfaces

2 x serial com ports
1 x parallel printer port
4 x USB (V1.10)
PS/2 keyboard/mouse
1 x 100Mbps Ethernet
2 x cash drawer control
AC97 audio
Magnetic Dallas card reader

Optional Modules

Internal magnetic card reader
Internal 2 x 20 VFD customer display
External floppy disc drive
External USB CD ROM/DVD ROM
External keyboard
External printing adaptor

Dimensions & Weight

Dimensions (W x D) 295 x 295mm
Height adjustable (190 - 230mm)
Weight 7.5 kg